

SOUTHGATE WEST

- 57,700 square feet
- Completed October 2001
- Typical Bay Size: 6,400 square feet (40' x 160')
- 40' x 40' Column Spacing
- Bays designed to accommodate 2 dock-high, front-load doors and a personnel door
- 26' clear ceiling height
- 120/240, three phase
- Single-seam metal roof, Butler system
- ESFR sprinkler system
- Ample parking
- 160' truck court



3093 Caruso Court

PMC PINELOCH
MANAGEMENT
CORPORATION

Post Office Box 568367
Orlando, Florida 32856-8367
Contact: Mary Hurley
407-859-3550
mary@pineloch.com
Website: www.pineloch.com

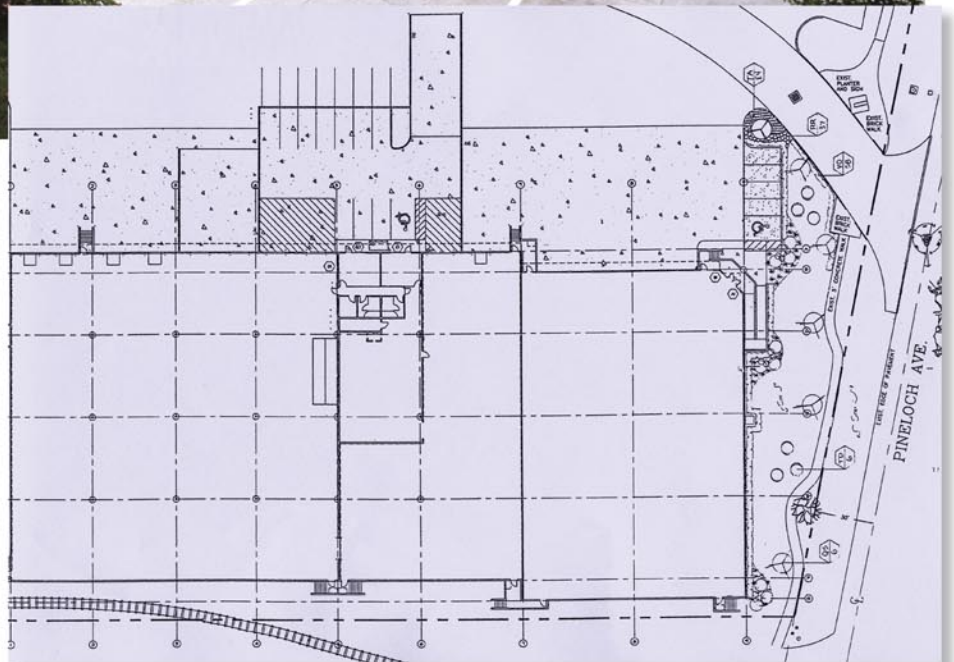

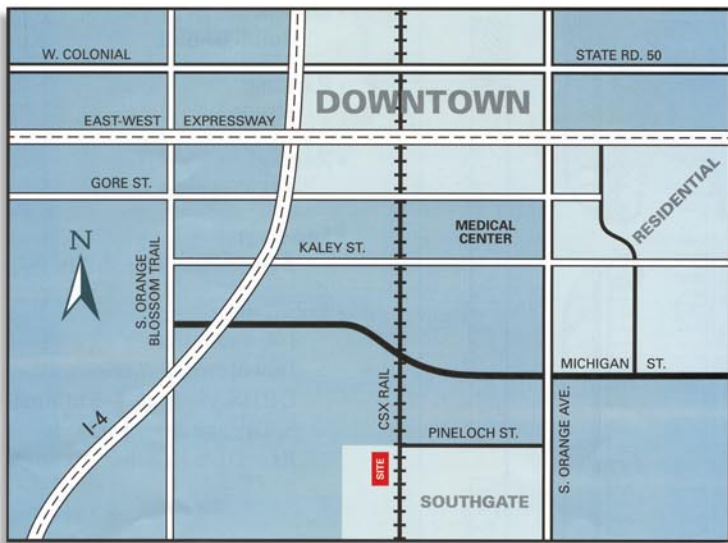

Southgate is a mixed-use development that includes Class A office space, light industrial, bulk warehouse space, and retail. The connectivity and location of Southgate provides accessibility to I-4, the Turnpike and the Beltway System, and is located within minutes of the Orlando CBD and the International Airport.

